

## 15. Rearview Camera System

### A: WIRING DIAGRAM

Refer to "Rearview Camera System" in the wiring diagram. <Ref. to WI-350, WIRING DIAGRAM, Rearview Camera System.>

### B: REMOVAL

1) Disconnect the ground cable from battery. <Ref. to NT-5, BATTERY, NOTE, Note.>

#### NOTE:

For models other than STI model, disconnect the ground terminal from battery sensor.

2) Remove the trim panel - trunk lid. <Ref. to EI-95, REMOVAL, Trunk Room Trim.>

3) Remove the garnish - trunk. <Ref. to EI-51, REMOVAL, Trunk Lid Garnish.>

4) Remove the rearview camera assembly.

#### CAUTION:

**Do not drop or apply any impact to the rearview camera because it is a precision equipment.**

(1) Disconnect the connector.

(2) Release the claw and hook, and then remove the rearview camera assembly.

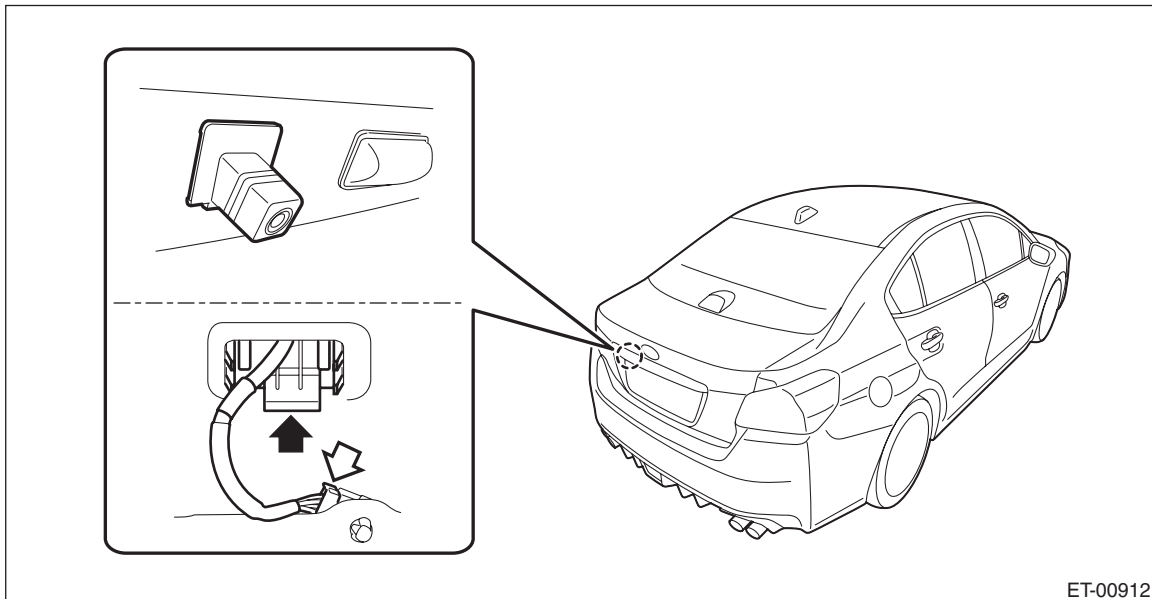

ET-00912

### C: INSTALLATION

1) Install the rearview camera assembly.

2) Install the garnish - trunk.

#### **Tightening torque:**

**4.5 N·m (0.5 kgf-m, 3.3 ft-lb)**

3) Install the trim panel - trunk lid.

4) Connect the battery ground terminal. <Ref. to NT-5, BATTERY, NOTE, Note.>

#### NOTE:

For models other than STI model, connect the ground terminal to battery sensor.

5) Confirm the marker position. <Ref. to ET-22, INSPECTION, Rearview Camera System.>

# Rearview Camera System

## ENTERTAINMENT

### D: INSPECTION

- 1) Park the vehicle at the level place where there are enough area at the rear of the vehicle.
- 2) Attach the tape as the target point for standard at the floor rearward of the vehicle as shown in the figure below.

#### NOTE:

Standard tape width is about 30 — 50 mm (1.18 — 1.97 in) and brilliant color shall be used.

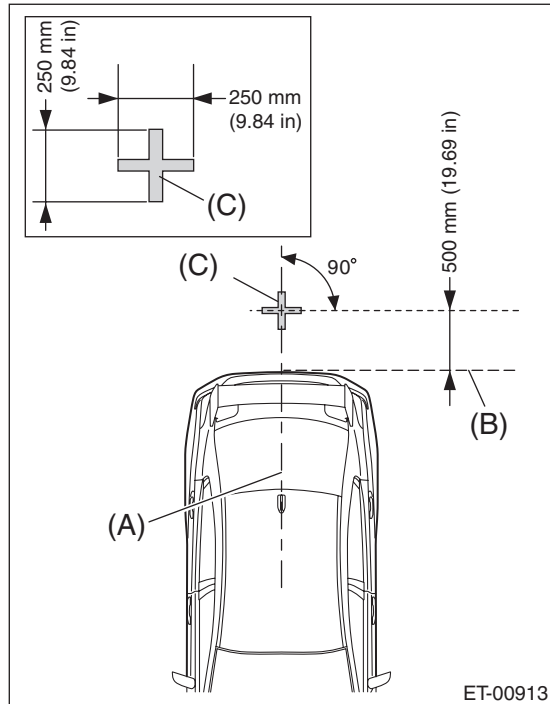

- (A) Vehicle body center line
- (B) Rear edge of bumper
- (C) Target point

- 3) Confirm the following before checking the corresponding items.

- When the display is blank:

Rearview camera image is not displayed. (The multi-function display screen is displayed normally.)

- Check the condition of back sensor and rearview camera connection. <Ref. to IDI-10, DIAGNOSTIC MODE, OPERATION, Multi-function Display (MFD) System.>

- When the marker position is not aligned:

- Adjust the marker position according to the MARKER ADJUSTMENT MODE. <Ref. to IDI-10, DIAGNOSTIC MODE, OPERATION, Multi-function Display (MFD) System.>

### E: ADJUSTMENT

#### 1. MARKER ADJUSTMENT MODE

For marker adjustment, refer to “INSTRUMENTATION/DRIVER INFO”. <Ref. to IDI-10, DIAGNOSTIC MODE, OPERATION, Multi-function Display (MFD) System.>